

Expertise and insight

for the future

BICYCLE PARKING

FALL 2012

JUUSO ANDERSIN / JANNICA JAHNSSON / SONJA SKOGSTER / MAXIME RICHARD



INTRODUCTION

Our aim in this project is to develop bicycle parking and storage solutions in Helsinki. We have explored bicycle parking solutions on the Internet and in central Helsinki. The main goal is to invent a new and innovative concept. The significant problem in Helsinki is the lack of safe and functional bicycle parking, and therefore it is in our interest to approach the problem from this angle.



- benchmarking
- material research
- technique research

- studying the prevention of crimes
- researching the traffic and infrastructure from a bikers point of view

DESIGN PROCESS

- combining the product and the space
- designing the atmosphere and the aesthetics

- understanding the problem
- visualizing the ideas

- product design
- sketching



RESEARCH

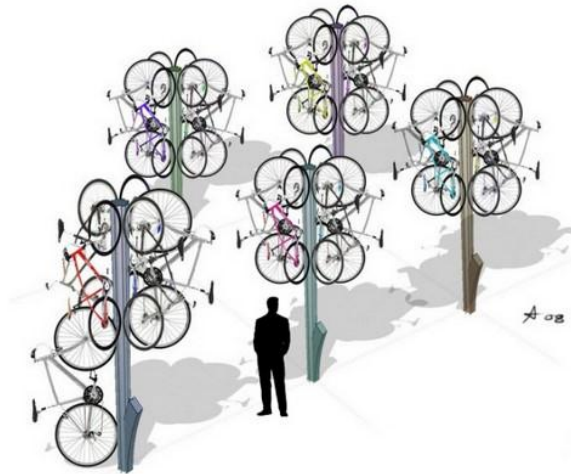

Basic bicycle dimensions

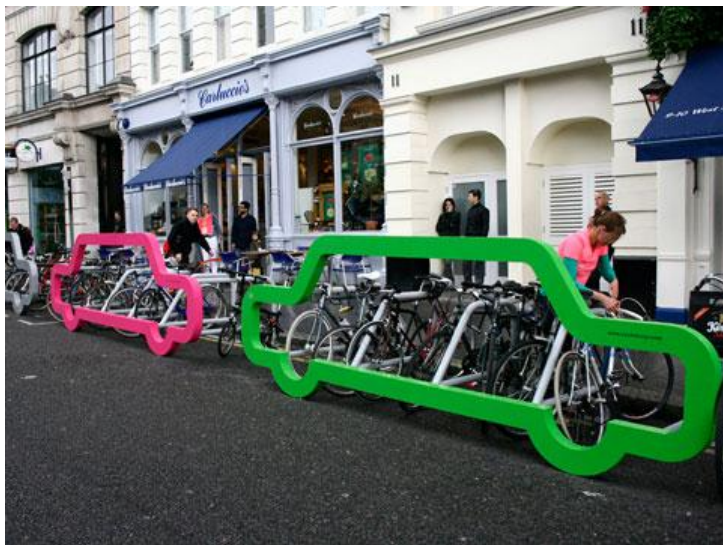

Eielerin aukio, central Helsinki



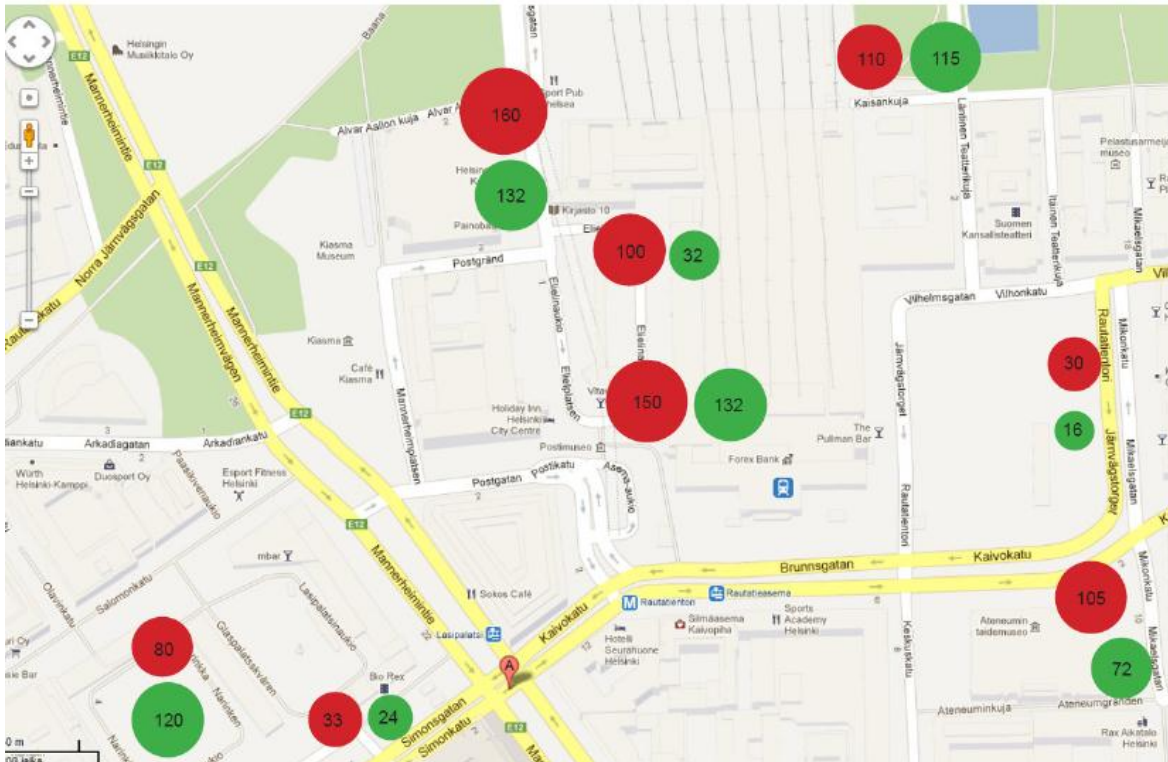

STATISTICS OF BICYCLE PARKING IN HELSINKI

The picture to the left contains bicycle parking in central Helsinki, near the railway station and bus terminals. There were 768 bicycles that needed parking, but there are only places for 611, which means that 157 bicycles did not fit the racks.

- Number of places in the bicycle racks
- Bicycles parked near the racks



PREVENTING CRIMES



Getting people involved, by making them feel that the place is theirs

- There could be an opportunity for people to have a effect on the appearance of the Eliel square and what kind of services there are
- Exhibitions in the Café, where normal people have a chance to show their work of art?

Good lighting

- making the risk to get caught simply too big to steal a bike
- Cold, white light has been discovered to be the best kind of a light in preventing crimes



Material selections: materials that send signals that they are for example too strong to break



SKETCHING

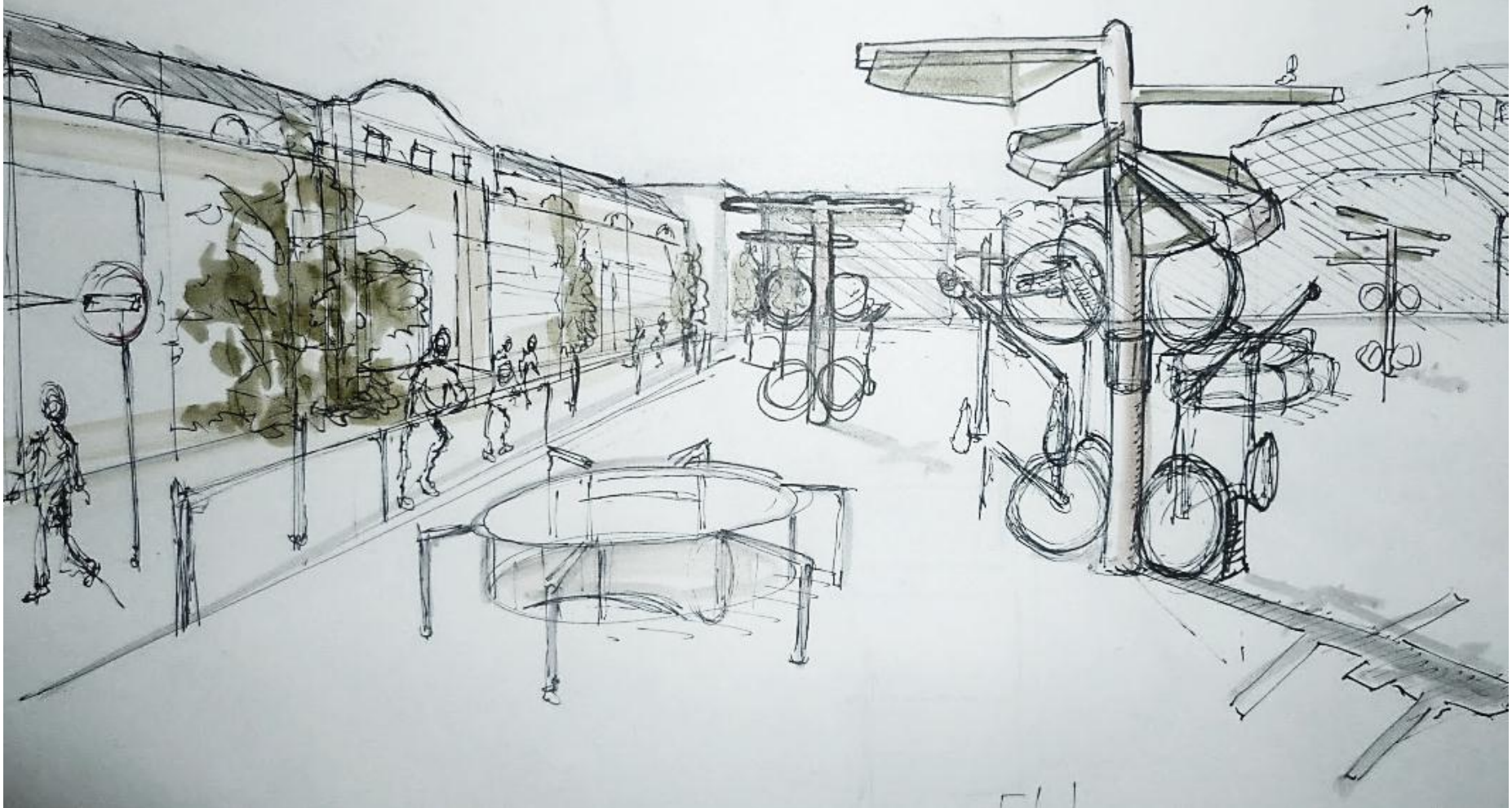

SKETCHING

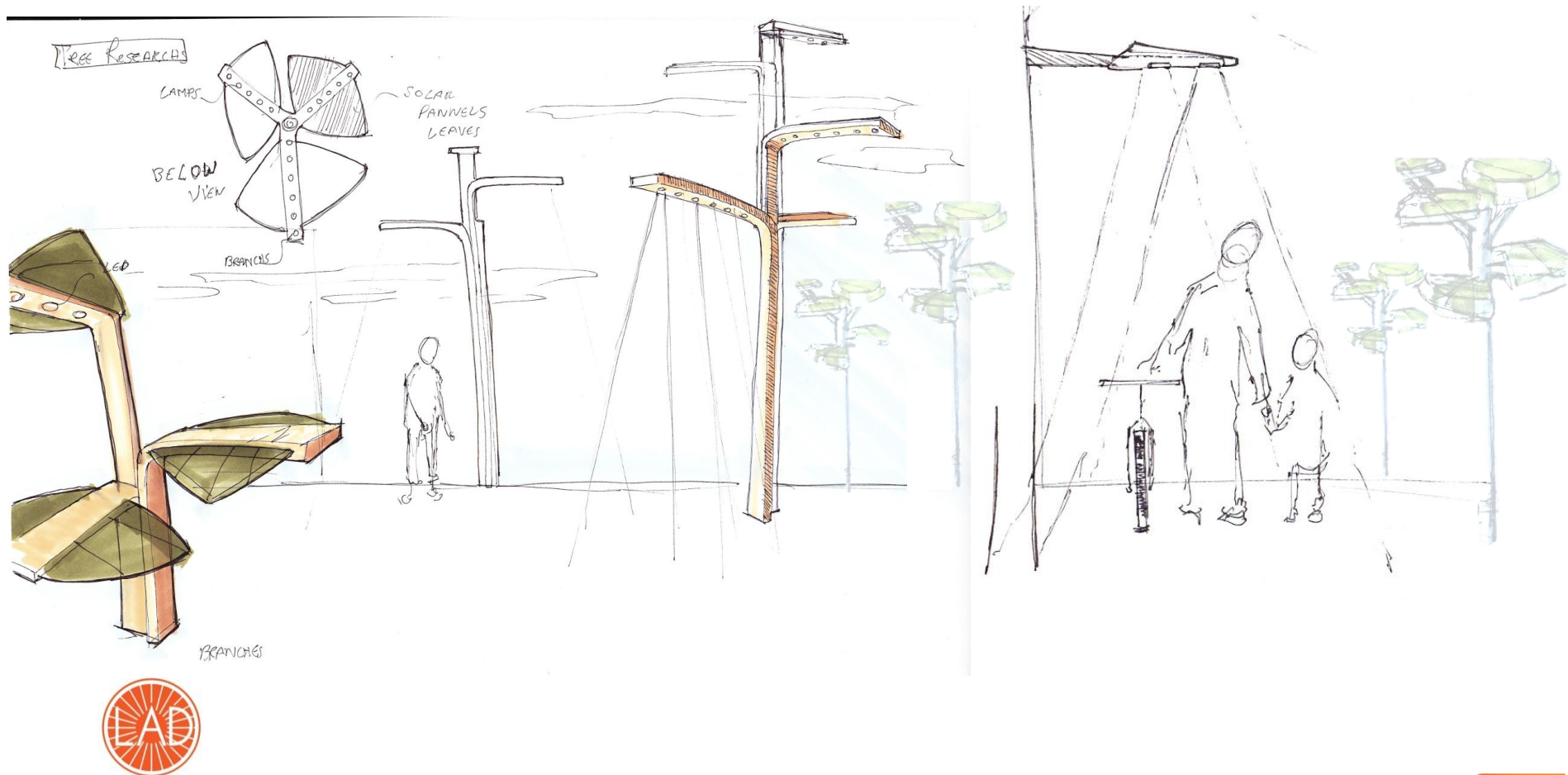

BICYCLE PARKING CONCEPT

The city of Helsinki wishes to increase cycling in Helsinki and decrease car traffic. The plan is to step by step make central Helsinki more pedestrian and biker friendly.

One step towards this is transforming the Eliel Square into a bicycle center. The idea is to make a meeting point where cycling routes and people can meet. A center for bicycles with different kinds of parking options, like underground parking, short term parking and bicycle storage. At the same time the square can be aesthetic and attractive, like a park which gives a “facelift” to the area. The area could offer other services like bicycle repair stations and cafeterias.

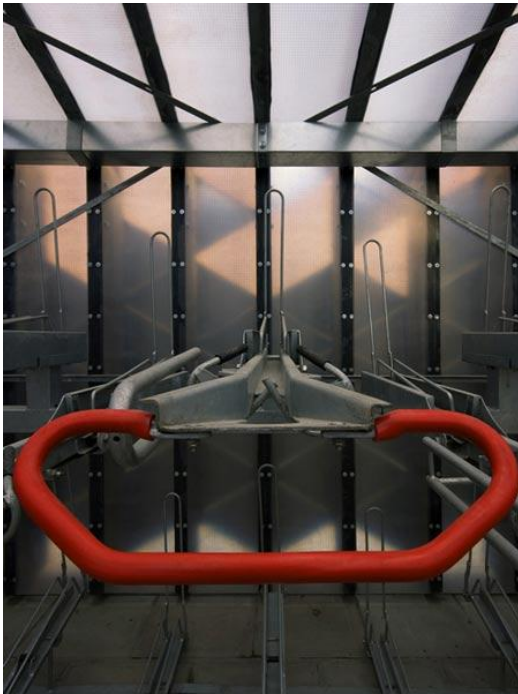



INSPIRATION



THEMES

single house
trees
garden
wood
architecture

USER GROUP

commuter cyclists
freetime cyclists
tourists
pedestrians

SERVICES

cafeteria
repair station
meeting point
deluxe parking (deposit boxes)



DESIGN

attractive
easy to approach
weather resistant solutions : leaves, that collect water
lightning at night
winter time monumental

PARKING OPTIONS

Short term parking outside
Volume parking underground : two layered racks
Deluxe deposit boxes

SECURITY

Maintainence
Supervivion
Lighting



LOCATION FOR BICYCLE PARK

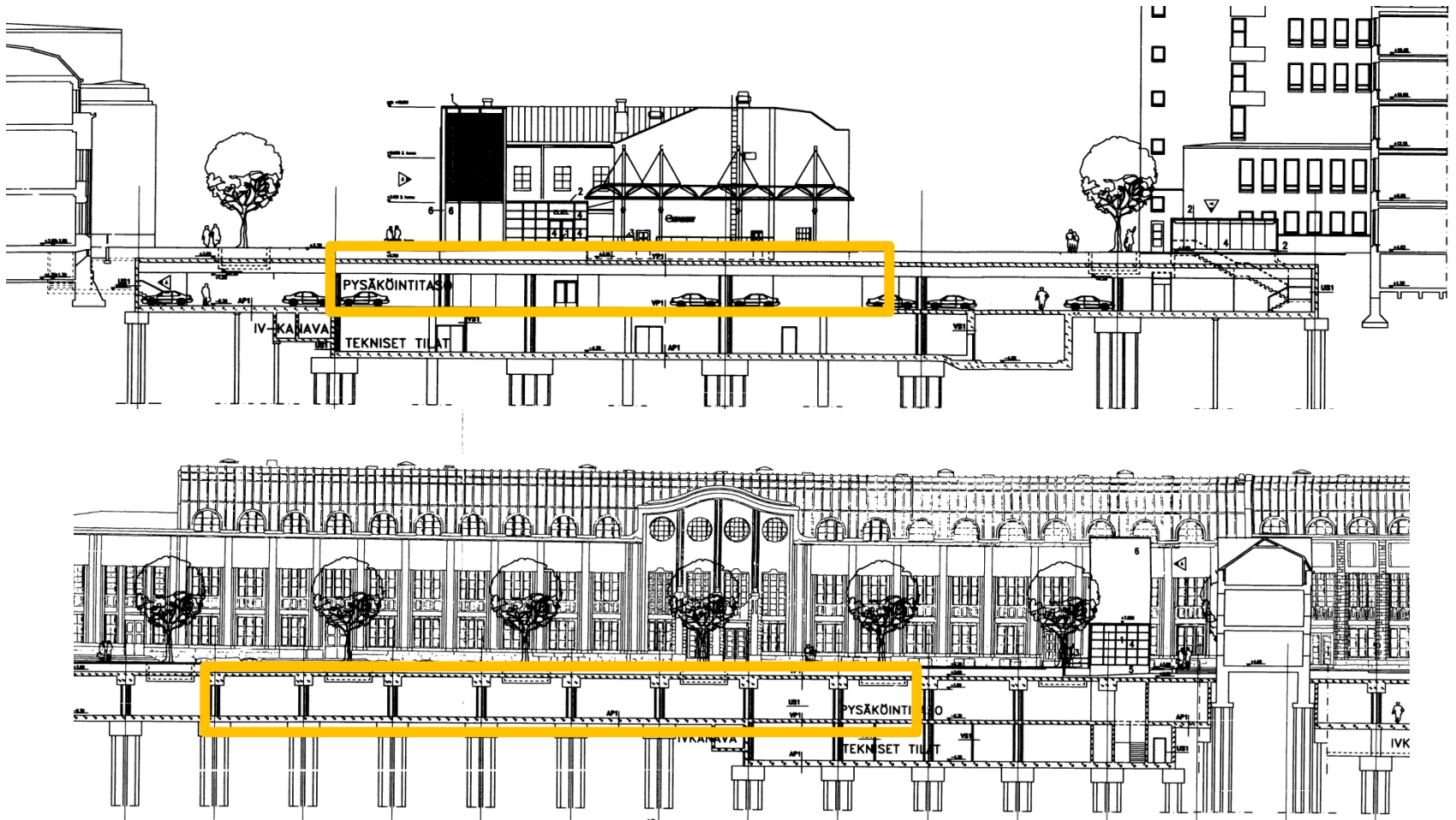

ELIEL SQUARE

Car free zone, allowed only for taxis and transportation.

The openings in the ground gives light to the underground parking at daytime. In the evening the light comes from underground. They also function as benches.

● Tree with lighting

||| Short term parking for 128 bikes

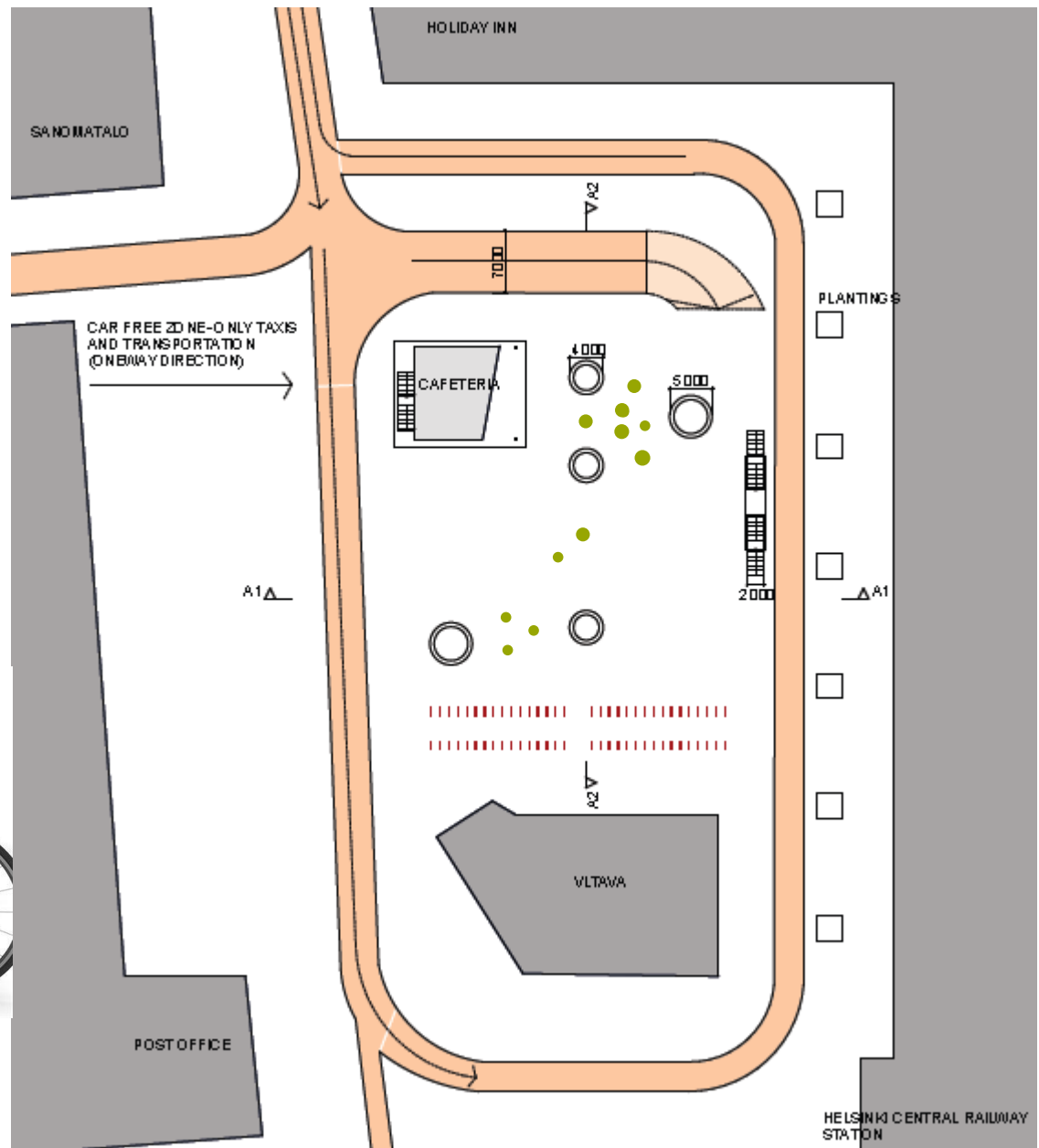

ELIEL BICYCLE PARK

With two storey bike racks the park hall will fit 1024 bikes.

Storage lockers for 25 bikes.

An area for bicycle repairing.

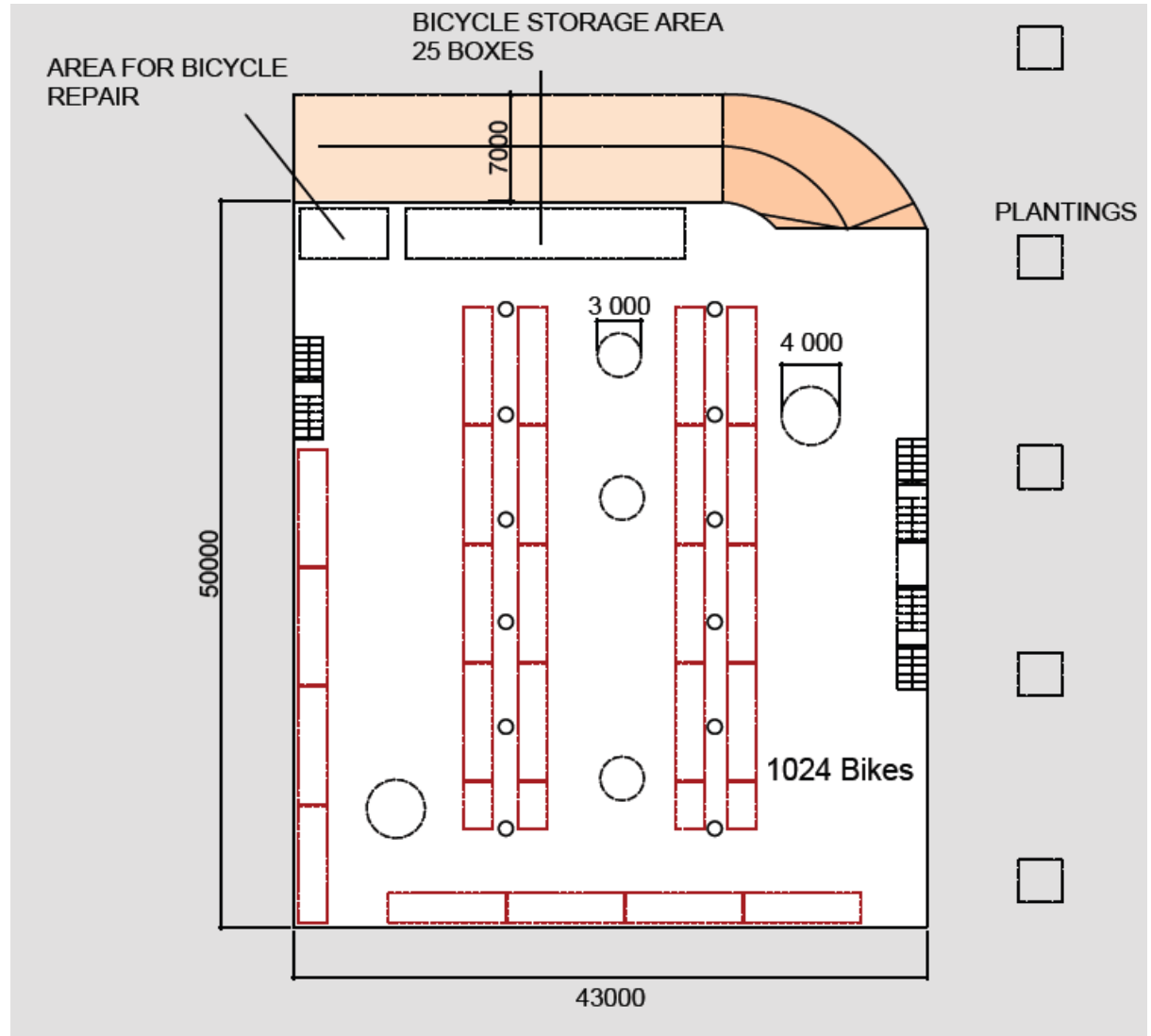
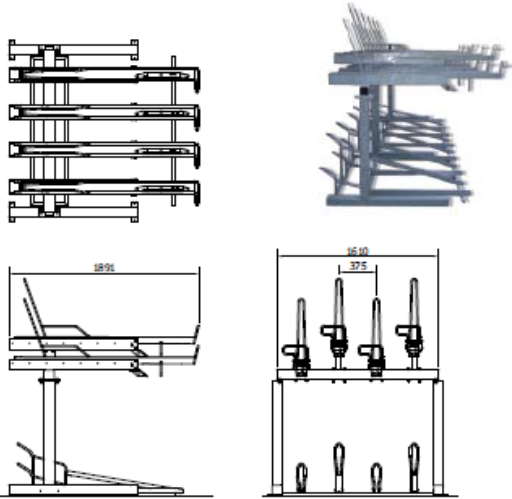

A1

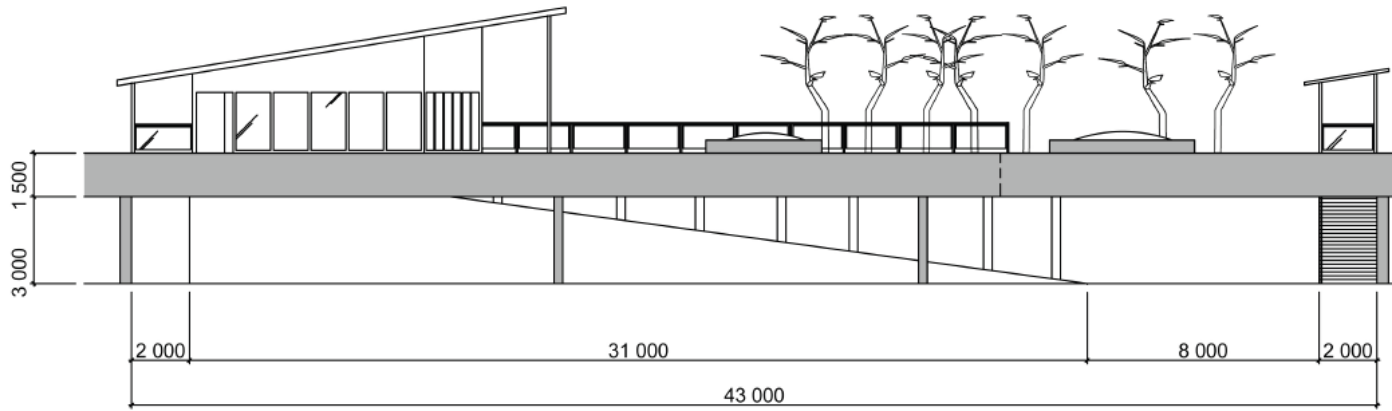

A2

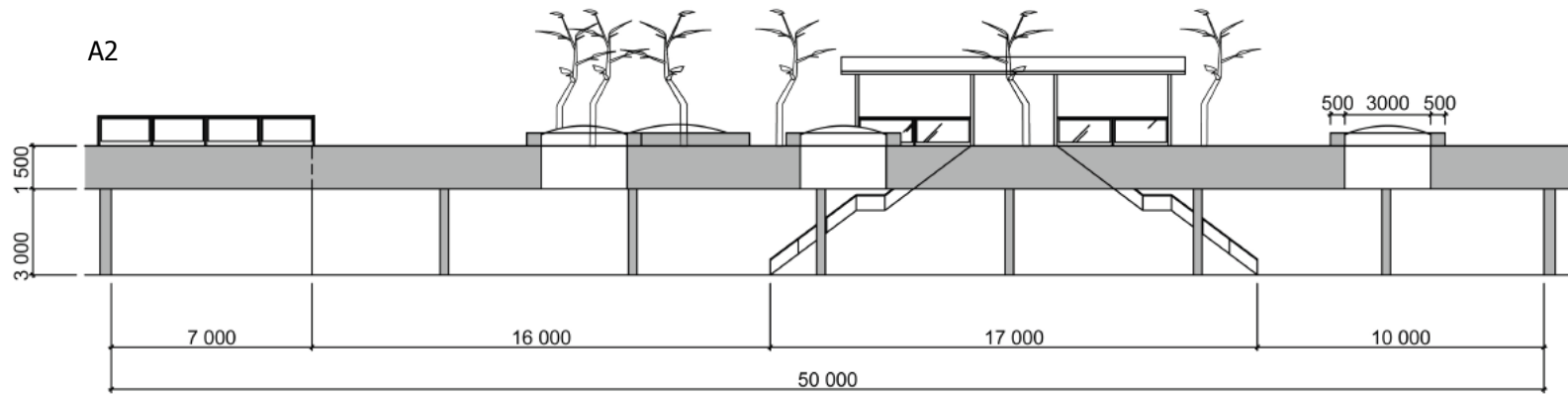



SOURCES

<http://www.falco.co.uk>

<https://asiointi.hel.fi/arska/>

<http://www.chicagobikestation.com/http://www.tut.fi/en/units/departments/business-information-management-and-logistics/research/transport-system-research/pykala-project/index.htm>

<http://www.tut.fi/verne/tutkimusalueet/kaupunkiliikenne/>

<http://www.thepolisblog.org/2010/03/bicycle-stations-new-architectural.html>

<http://ecologicalurbanliving.blogspot.fi/2011/01/fietsappel.html>

<http://jimsbikeblog.wordpress.com/2010/02/26/where-bikes-hang-in-trees/>

<http://plusmood.com/2011/01/update-of-bicycle-transit-center-more-images-drawings-diagrams/>

<http://www.google.fi/imghp?hl=fi&tab=wi>



