

Bicycle Center 2.0



Elina Niemi, Aleksandr Pylsy,
Tomas Peltola, Aaro Kurkela

Future plans



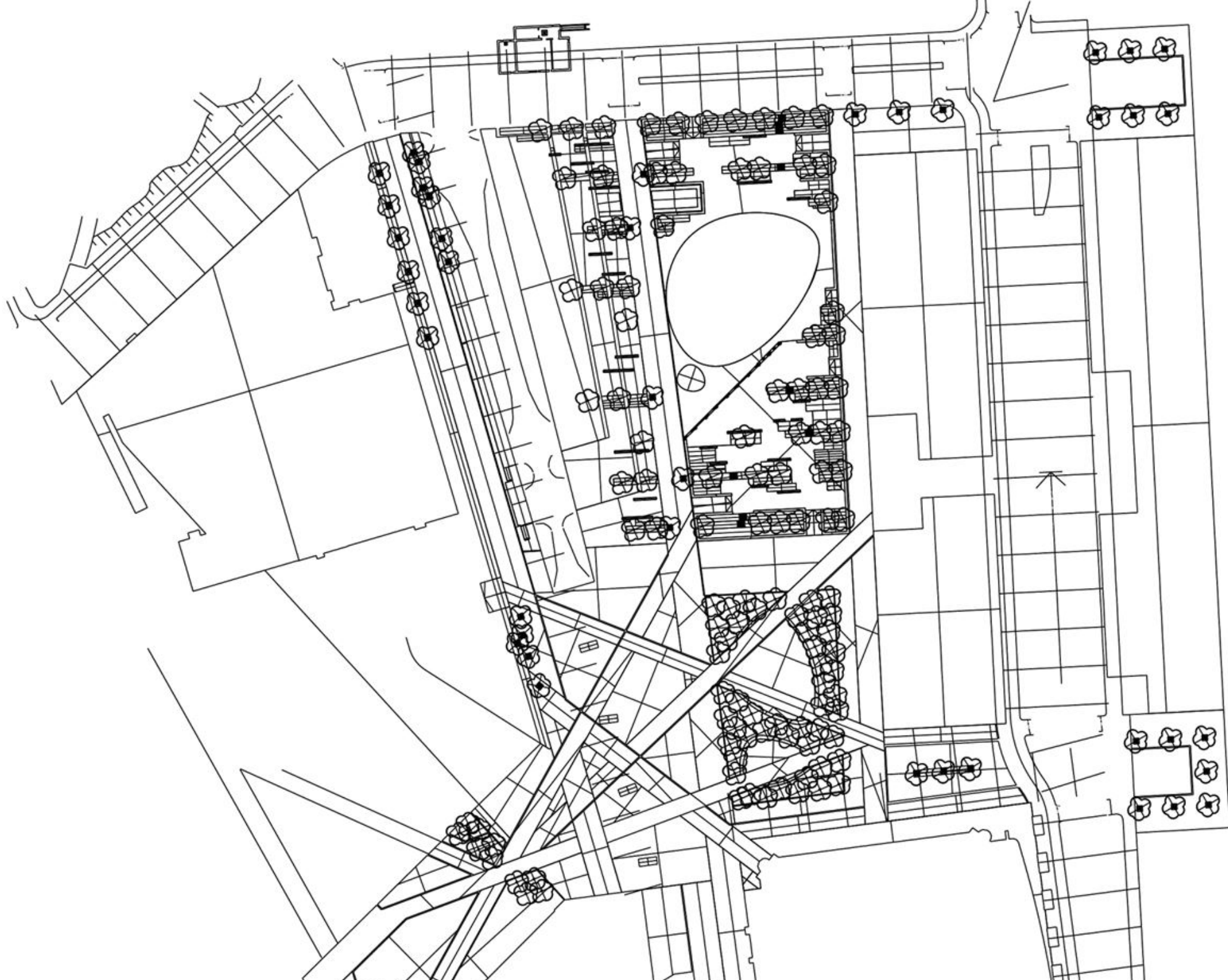



Current situation



Tervetuloa Musiikkitalon terassille!
Tapahtumaravintolat.fi

View from south



View from North



View from Baana



Proposed plot for Bicycle center 2.0

Abandoned remnants of VR warehouses demolished after they were badly damaged in a fire.

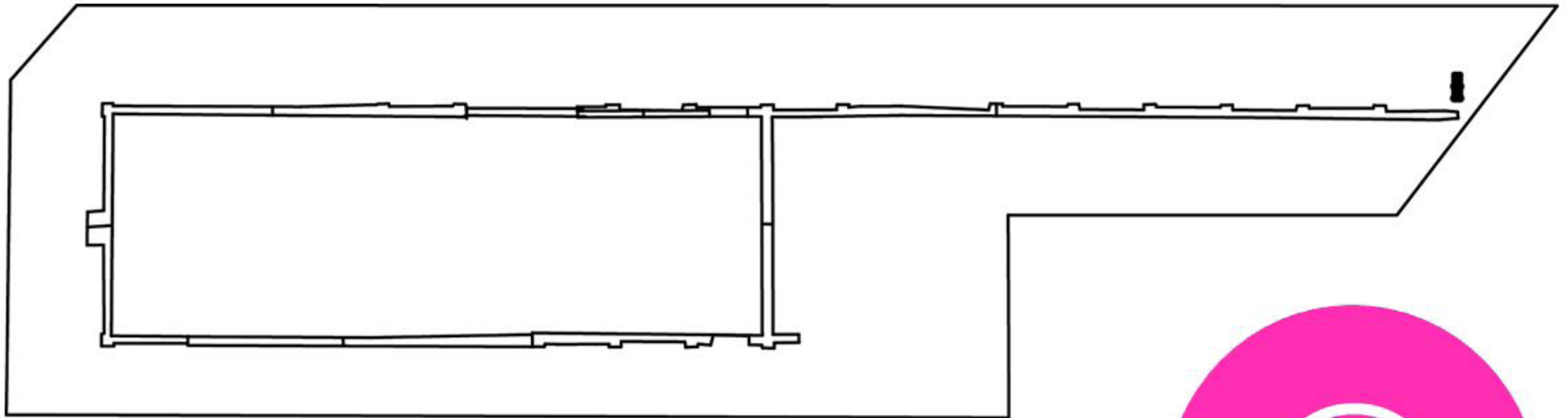

Renovation of the structure would provide abundant space for the new bicycle center with no need to build completely new structures.

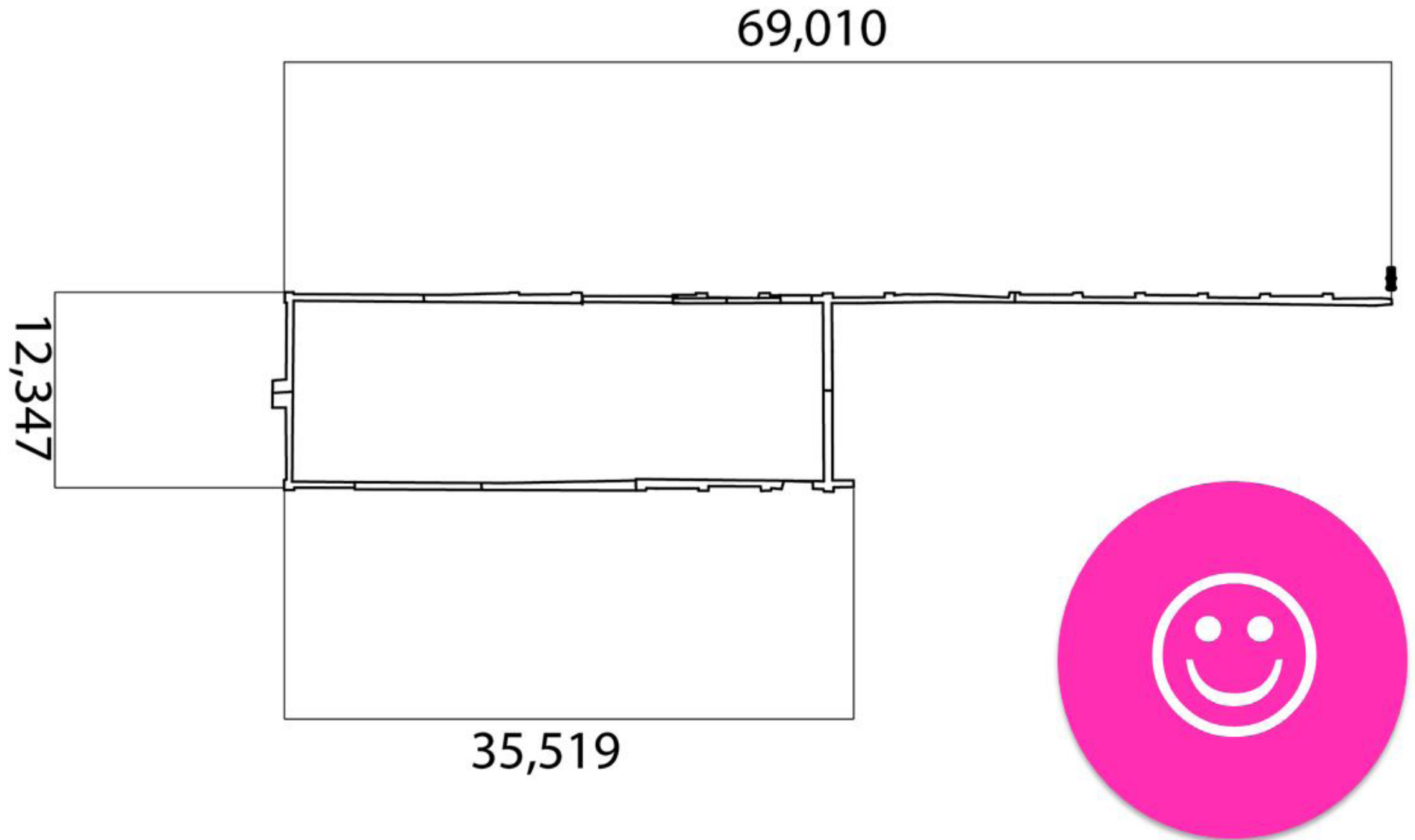

The surrounding plot has plenty of space for bicycling related activities and will seamlessly merge into the surrounding park.

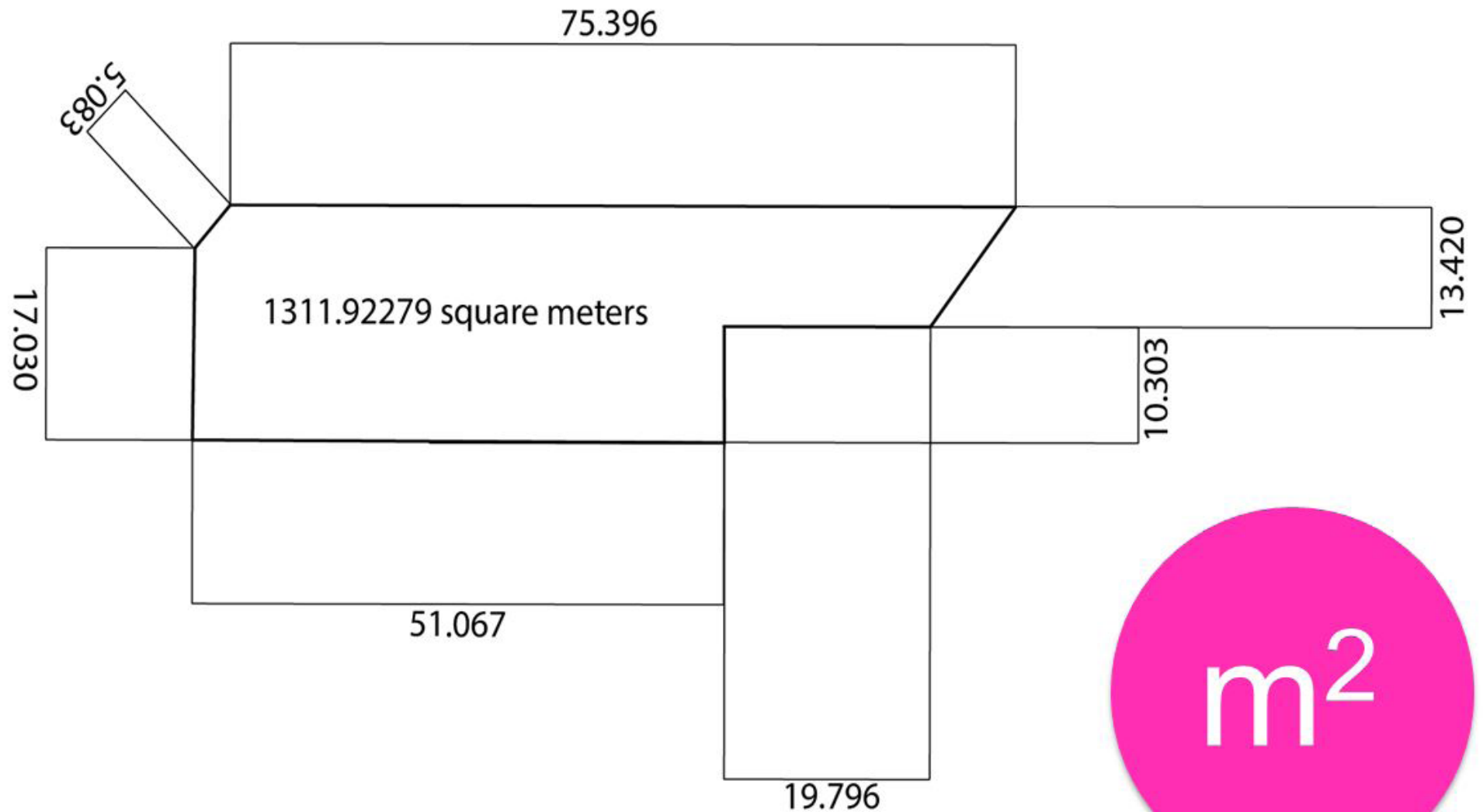

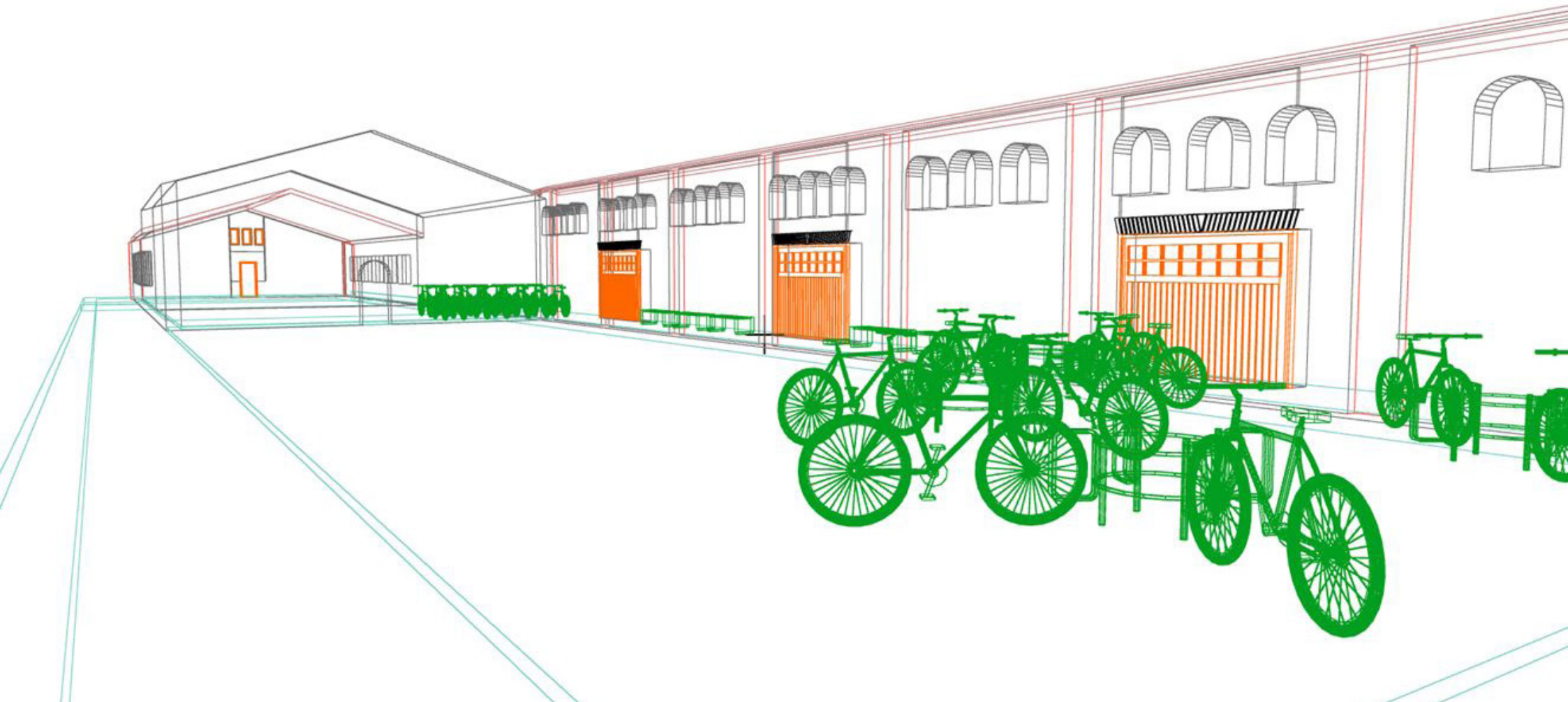
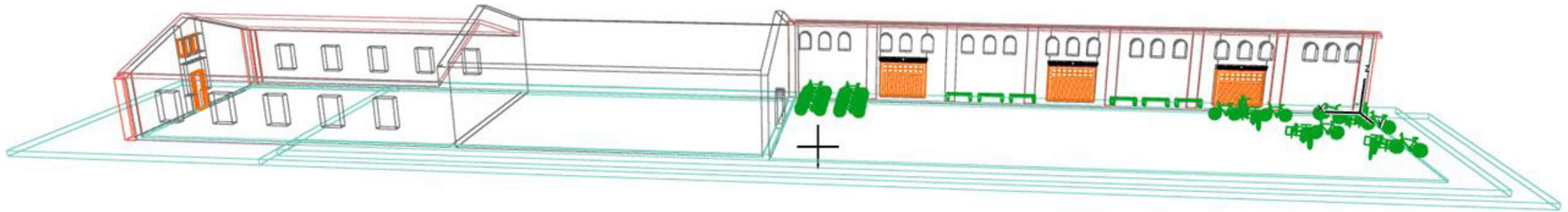



Facilities

- Shop
- Lockers
- Info
- Hanging area

- Inside Parking
- Repair center
- Café
- Toilets
- Showers

- Parking
- Outside repair station 24/7
- Info
- Terrace
- Good company and lots of other cyclists ;)

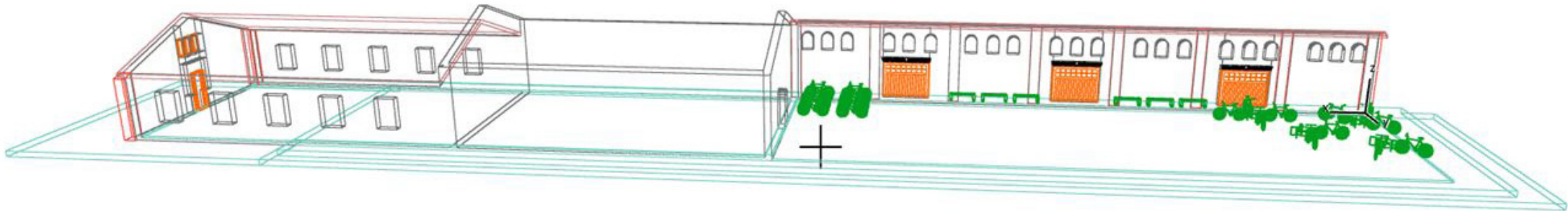

Parking

There is a growing need for secure parking space in the city center.

The new center will provide plenty.

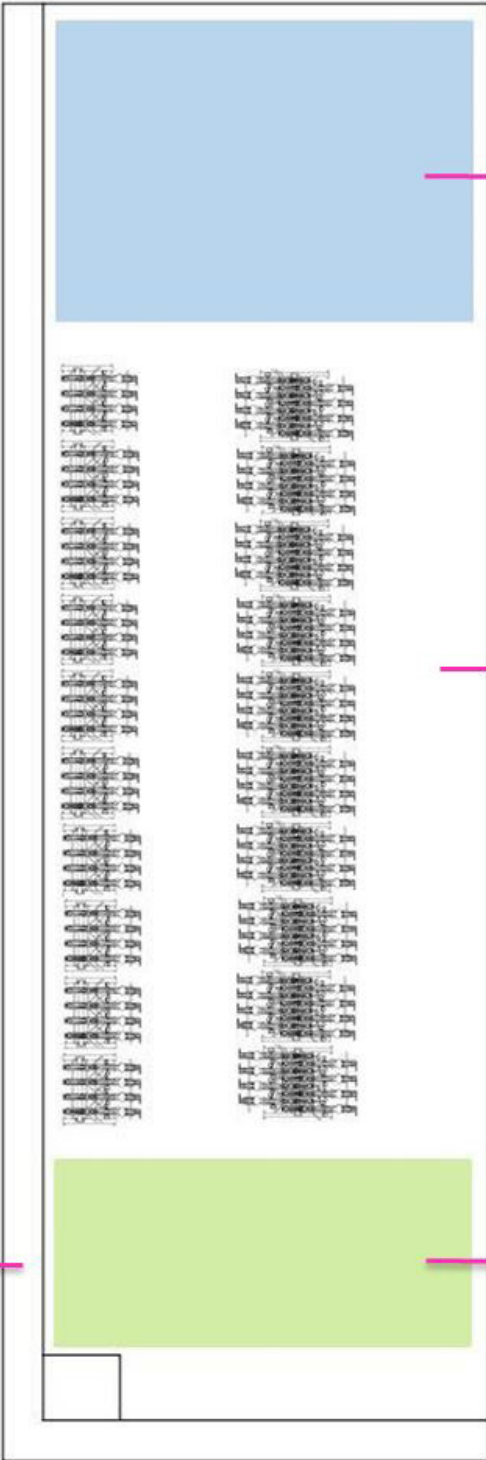

Outside repair area

Supervised parking for 240 bicycles

Warehouse wall

Cafe

Bike repair

The new center will have much more space for repair and maintenance.

Outside working hours people can use a tool-rack on the outside of the building.



Infodesk

The new bicycle center will have a large infocenter and counter capable of handling all the business transactions of the center.

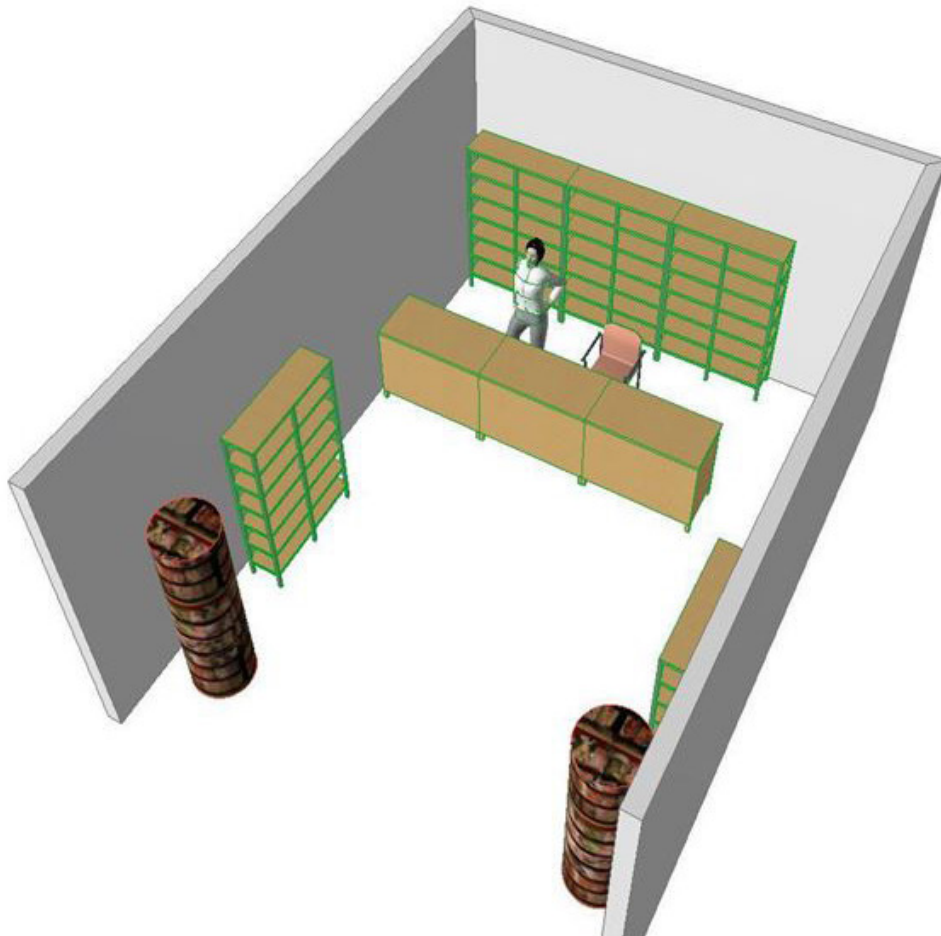

| |
|--------------------------|
| Office |
| 003 |
| A: 19,279 m ² |
| <floor type> |
| H: 2,70 m |

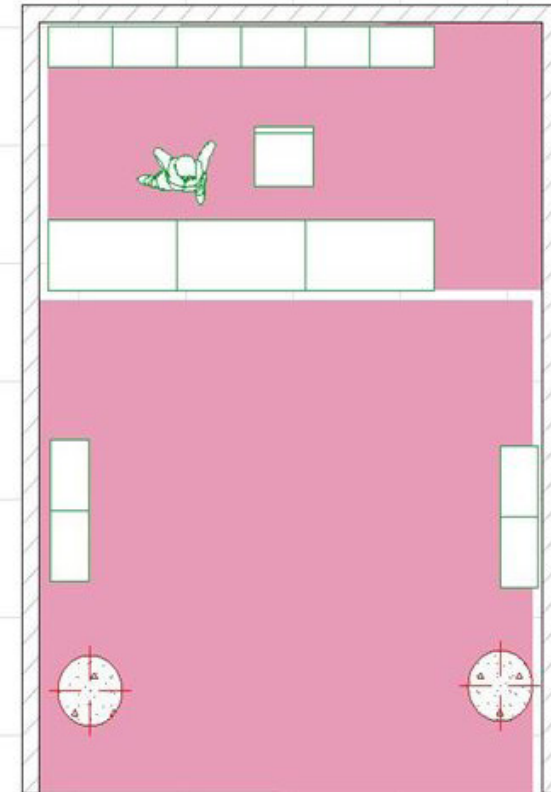

Services

Additional services of the center will be:

- WC, showers
- Membership services
- Accessory loan and store
- Bicycle renting
- Tools store

