



KIVISTÖ
AREA
FINLAND

•
BIKE
PARKING



FIRST IDEA CONTAINER PARKING



Near a forest road.

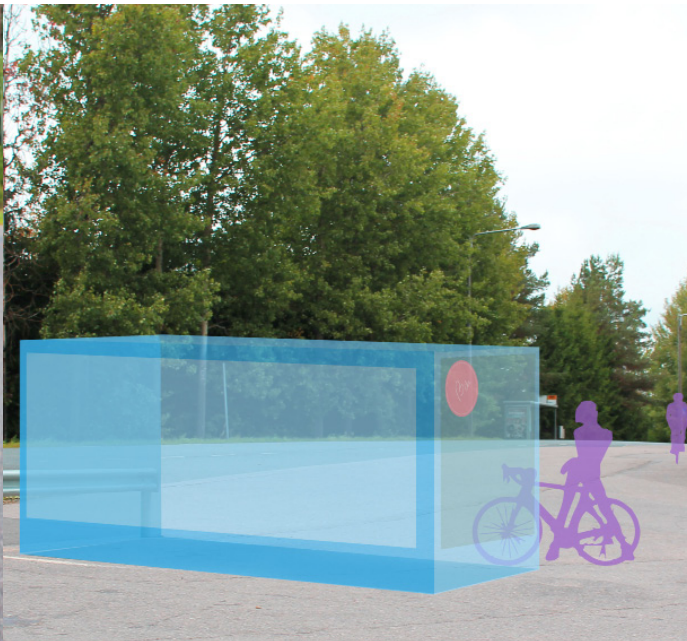

In a residential area.



Under a bridge.



Near a train station.



THE CONCEPT DRAWINGS & IDEAS

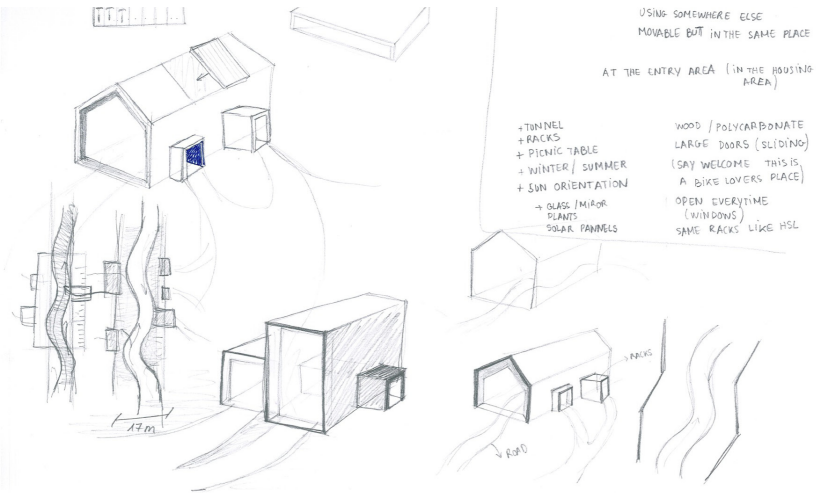

USING SOMEWHERE ELSE
MOVABLE BUT IN THE SAME PLACE
AT THE ENTRY AREA (IN THE HOUSING AREA)

- + TUNNEL
- + RACKS
- + PICNIC TABLE
- + WINTER / SUMMER
- + SUN ORIENTATION
- + GLASS / MIRROR
- + PLANTS
- + SOLAR PANELS

WOOD / POLYCARBONATE
LARGE DOORS (SLIDING)
(SAY WELCOME THIS IS
A BIKE LOVERS PLACE)
OPEN EVERYTIME
(WINDOWS)
SAME RACKS LIKE HSL

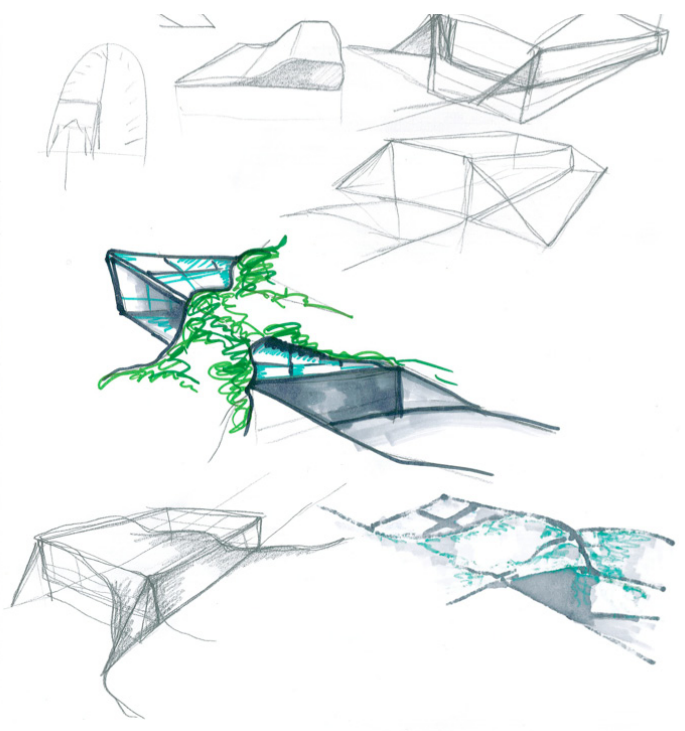
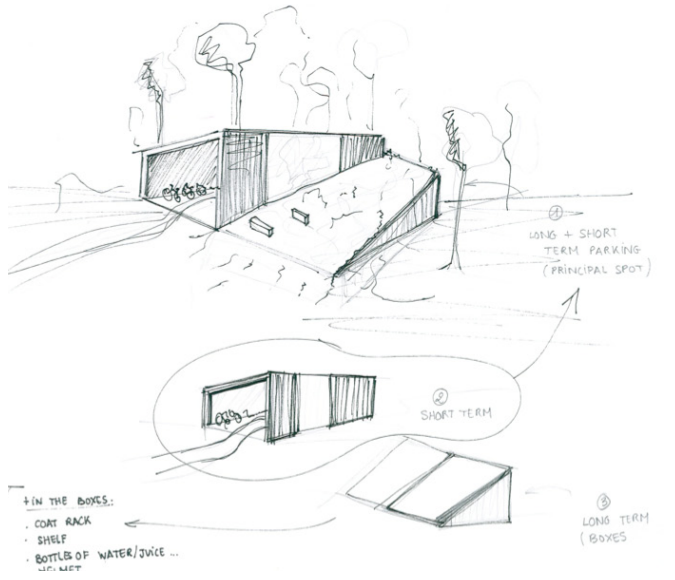
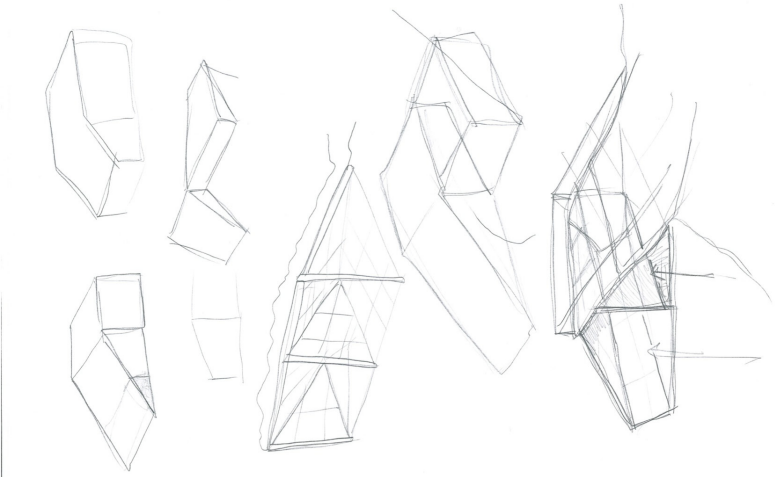
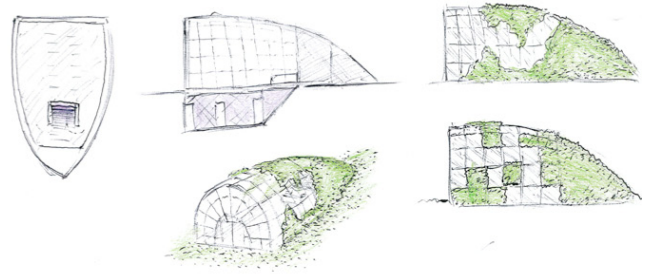

OUR FINAL IDEA



SHORT TERM

RACKS > main door which works with HSL-travel card.

LONG TERM

HSL deposit boxes which works with travel card.

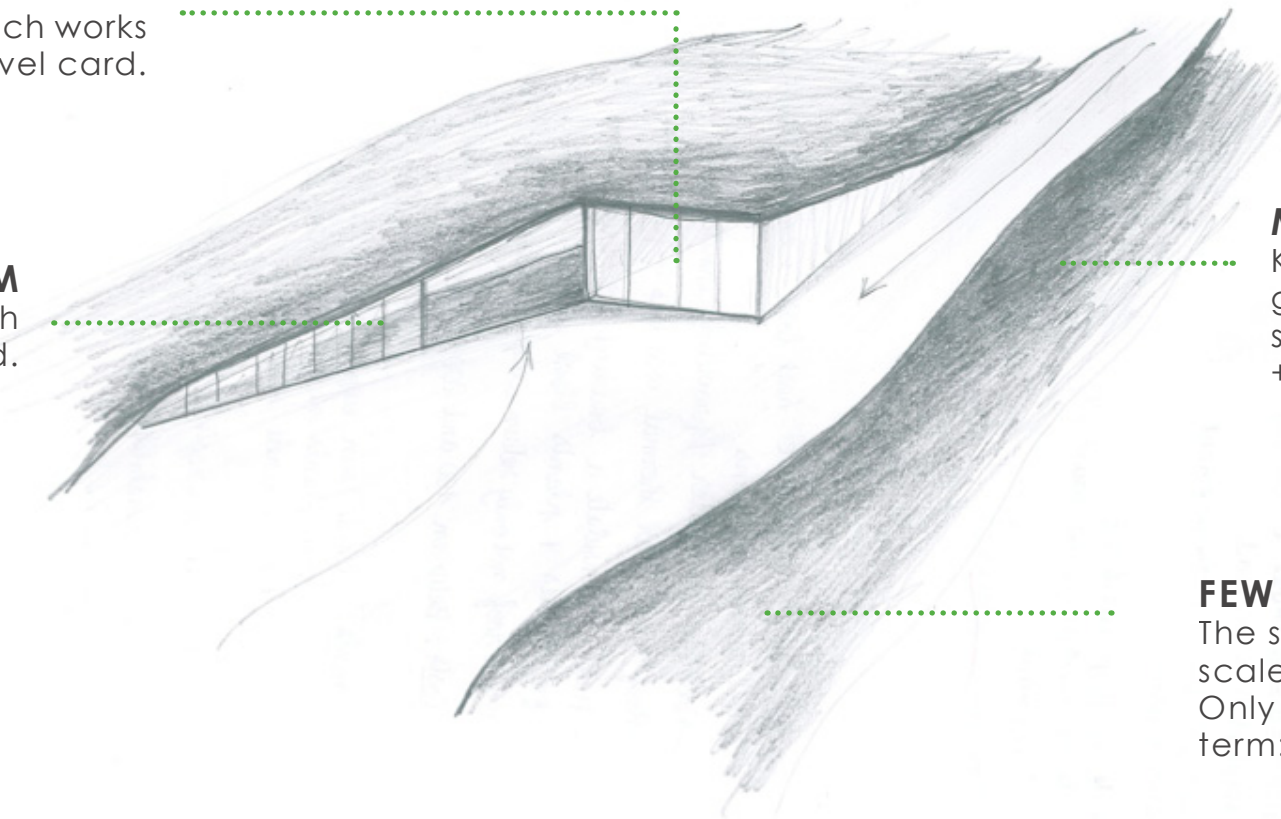

MATERIALS

Kivistö wants specially: glass; green-roof/plants, solar panels + wood and concrete.

FEW OPTIONS

The structure can be scaled.
Only long-term/short-term: works on their one.

IDEA:

The parking bike grows up from the ground.



OUR FINAL IDEA



Coral Carpet
Sedum album



Lidakense
Sedum caudicola

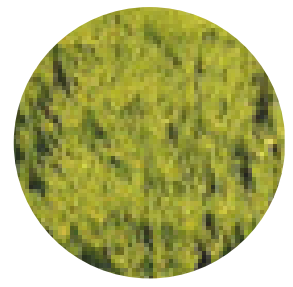
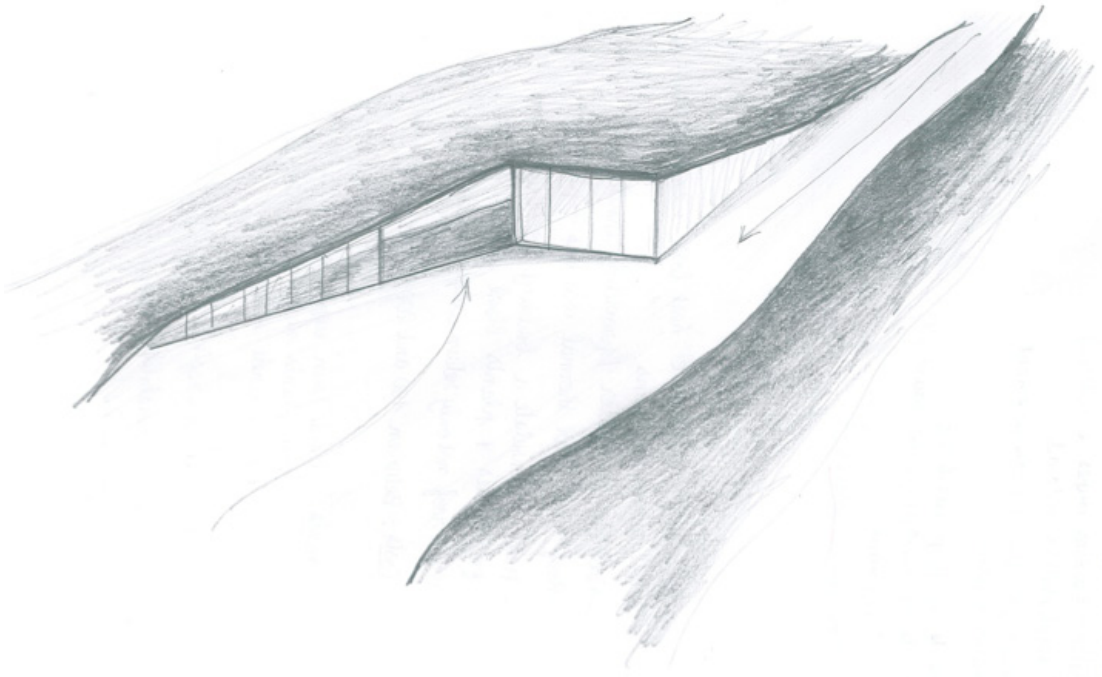

Sedum sexangulare



Prairie dropsed



Sedum acre



THE GREEN ROOF SYSTEM



THE ADVANTAGES OF A GREEN ROOF

Reduce heat loss, energy consumption in winter conditions.

Absorbing rainwater, providing insulation.

Roof with solar thermal collectors & photovoltaic panels.

Insulate building for sound: the soils helps to block lower frequencies & plants block higher frequencies.

Moderate the temperature of the water.

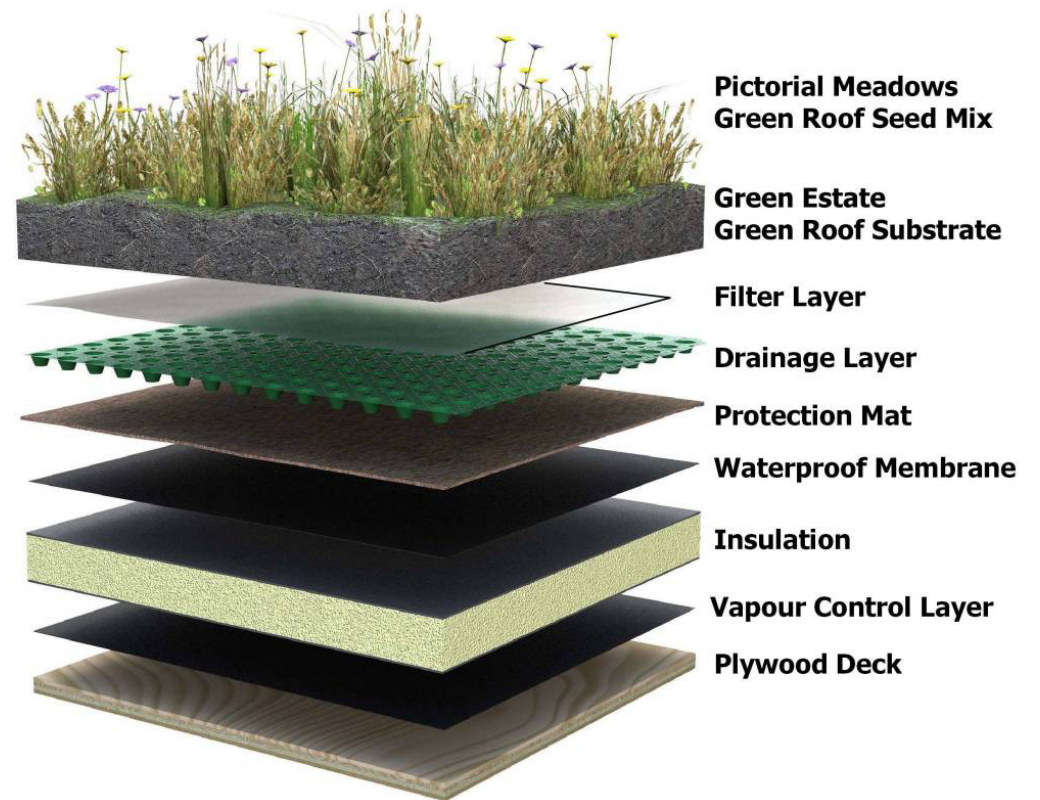

THE DIMENSION HSL BOXES



ONE BIKE PARKING PLACE:

DIMENSIONS: 0,75 x 1,2 m

HSL DEPOSIT BOXES:

1,20 x 1,80 m / height 2,5 m

Longer of 3 boxes next to another: 3,6 m.

BICYCLE:

Size of one bike:

1800 x 600 cm

Size of one bike and bike trailer:

2600 x 800

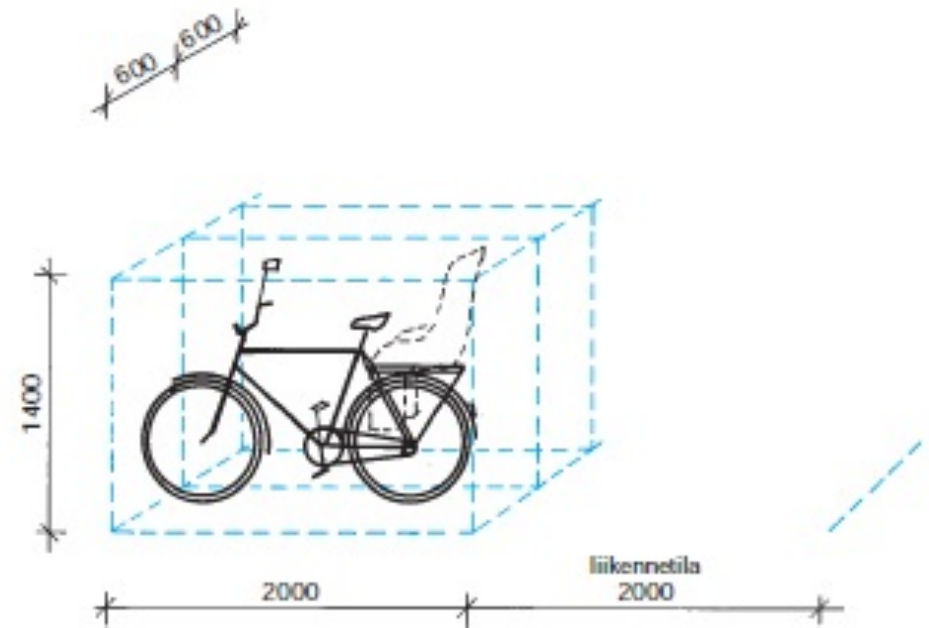

TIME TABLE



WEEK 40

3D or prototype

Photomontages

Illustrations of the different possibilities

Drawings

Lighting systemm

WEEK 41

Finalization of the project

Lay-out of the presentation.



BIBLIOGRAPHY & REFERENCES



IMAGES

<http://www.pinterest.com/pin/82824080619788101/>

http://25.media.tumblr.com/tumblr_md0k41q6pW1r89buwo1_1280.jpg

<http://boomerreviews.com/10-great-solopreneur-jobs-for-baby-boomers/solopreneur-dog-walker/>

<http://www.emcdda.europa.eu/topics/young-people>

http://www.woophy.com/forum/9_5517_1.html

<http://www.designboom.com>

http://www.google.com/imgres?imgurl=http://www.greenestate.org.uk/UserFiles/Image/newlandscape/green_roof_system.jpg&imgrefurl=http://www.greenestate.org.uk/material_supply22&h=797&w=1000&sz=115&tbnid=KoA6x5YrE36UEM:&tbnh=90&tbnw=113&zoom=1&usg=__HIC5NmUnwQ-2Fyx-uahyO697Ydo=&docid=fQmREedHOp8wWM&sa=X&ei=FDIIUvmdEcWThgflh4HADA&ved=0CEUQ9QEwBA

RT 98-10631: POLKUPYÖRIEN PYSÄKÖINTI JA SÄILYTYS/ kesäkuu 1997/checked 18.09.2013

RESEARCH

<http://vantaainnovation.fi/en/welcome-to-vantaa/>

<http://www.greenroofs.org>

<http://www.green-roof.be/fr/accueil/>

